

Property Highlights

- Orlando MSA
- Located at signalized intersection on State Road 434
- 4 per 1,000 SF parking ratio
- High residential density
- Suites with back deck overlooking a beautiful lake with fountain views
- Short term leasing opportunity
- Traffic Count (2013): 33,000 CPD

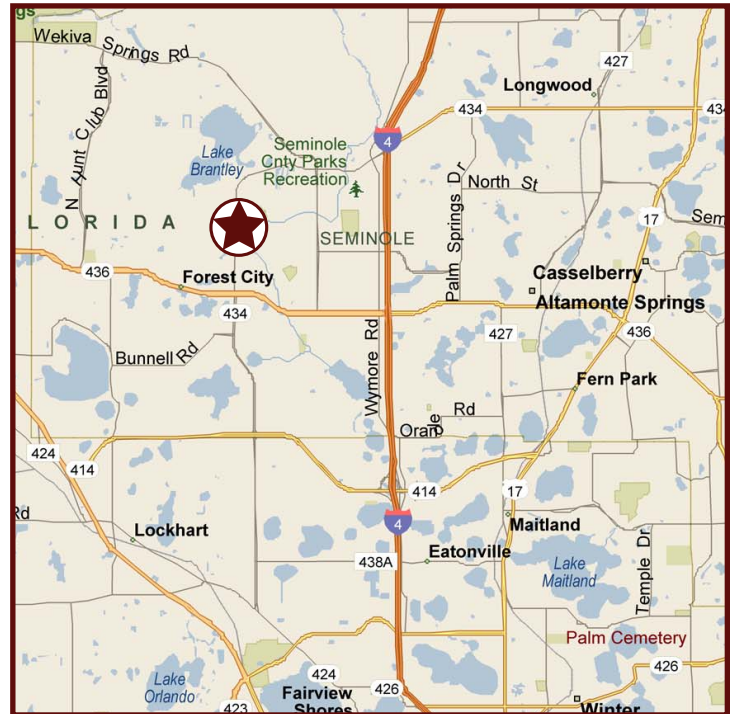

Leasing Contact:
Rochelle DuBrule
407-581-6248
rdubrue@crossmanco.com

For a complete directory of our listings visit our website:
www.crossmanco.com

No warranty expressed or implied has been made to the accuracy of the information provided herein, no liability assumed for error omission
Licensed Real Estate Broker

Site Plan

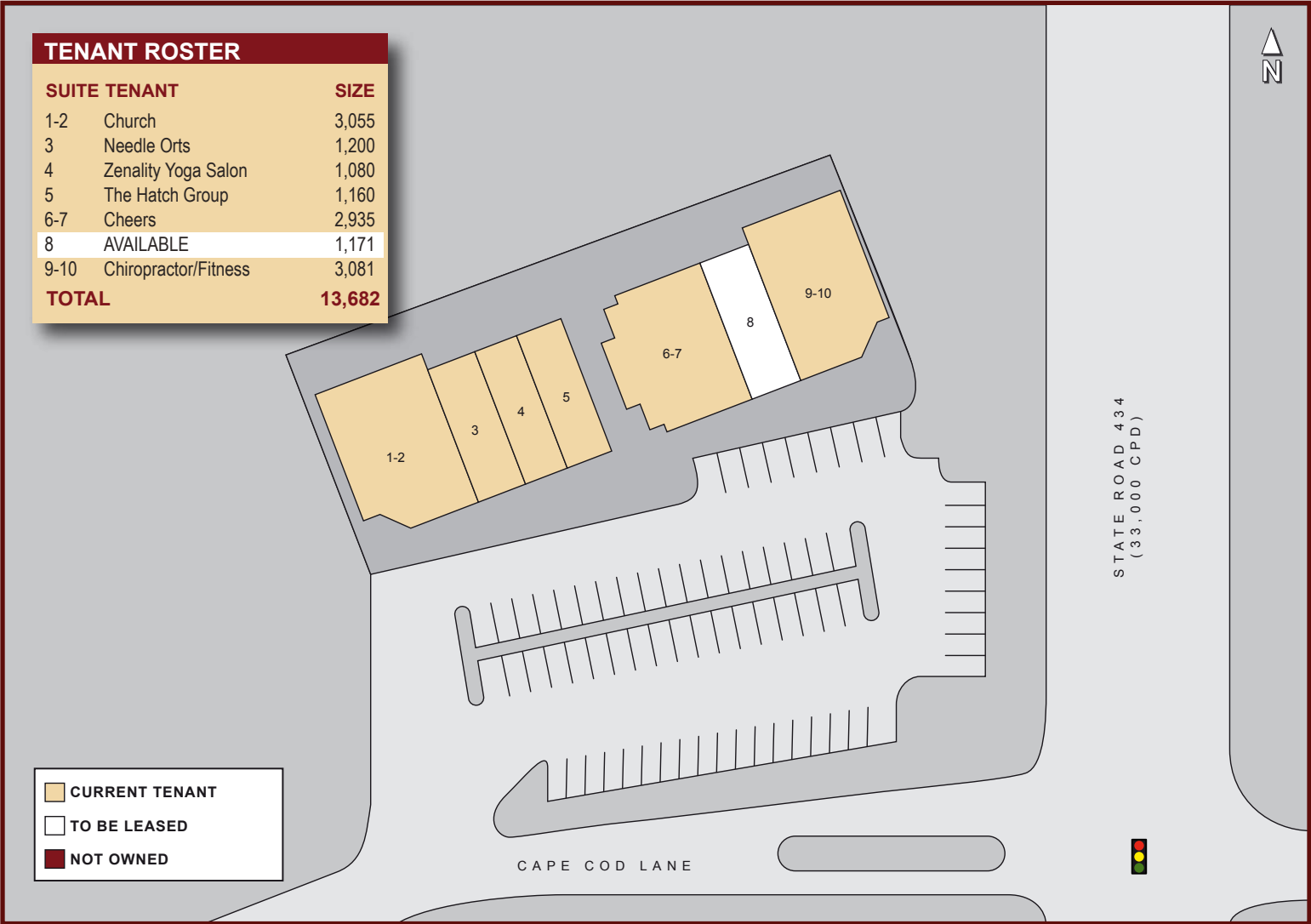

Leasing Contact:
Rochelle DuBrule
 407-581-6248
 rdubrue@crossmanco.com
www.crossmanco.com

Demographics	1-Mile Radius	3-Mile Radius	5-Mile Radius
2013 Population	11,047	93,355	194,001
2018 Population	11,668	97,079	203,377
2013 Average HH Income	\$65,842	\$70,606	\$68,573
2013 Median HH Income	\$53,465	\$52,172	\$49,975